

Dell PowerEdge T6\$"

Getting Started With Your System



⚠ WARNING: Before setting up your system, review and follow the safety instructions that shipped with the system.

🔧 NOTE: The documentation set for your system is available at [dell.com/poweredgemanuals](#). Always check for updates and read the updates first because they often supersede information in other documents.

🔧 NOTE: Ensure that the operating system is installed before installing hardware or software not purchased with the system. For more information on supported operating systems, see [dell.com/ossupport](#).

🔧 NOTE: To convert your system to a rack, see [dell.com/poweredgemanuals](#).

⚠ WARNING: Before setting up your system, review and follow the safety instructions that shipped with the system.

🔧 NOTE: The documentation set for your system is available at [dell.com/poweredgemanuals](#). Always check for updates and read the updates first because they often supersede information in other documents.

🔧 NOTE: Ensure that the operating system is installed before installing hardware or software not purchased with the system. For more information on supported operating systems, see [dell.com/ossupport](#).

🔧 NOTE: To convert your system to a rack, see [dell.com/poweredgemanuals](#).

⚠ WARNING: Before setting up your system, review and follow the safety instructions that shipped with the system.

🔧 NOTE: The documentation set for your system is available at [dell.com/poweredgemanuals](#). Always check for updates and read the updates first because they often supersede information in other documents.

🔧 NOTE: Ensure that the operating system is installed before installing hardware or software not purchased with the system. For more information on supported operating systems, see [dell.com/ossupport](#).

🔧 NOTE: To convert your system to a rack, see [dell.com/poweredgemanuals](#).

⚠ WARNING: Before setting up your system, review and follow the safety instructions that shipped with the system.

🔧 NOTE: The documentation set for your system is available at [dell.com/poweredgemanuals](#). Always check for updates and read the updates first because they often supersede information in other documents.

🔧 NOTE: Ensure that the operating system is installed before installing hardware or software not purchased with the system. For more information on supported operating systems, see [dell.com/ossupport](#).

🔧 NOTE: To convert your system to a rack, see [dell.com/poweredgemanuals](#).

Setting Up Your System | Setting Up Your System | Setting Up Your System | Setting Up Your System

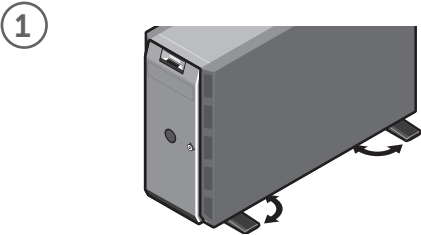

1

Extend the system feet to stabilize the system.

Extend the system feet to stabilize the system.

Extend the system feet to stabilize the system.

Extend the system feet to stabilize the system.

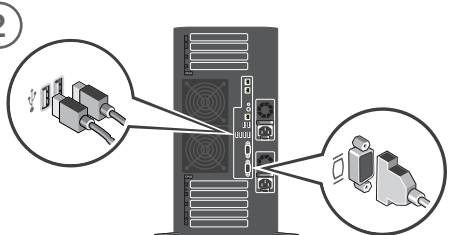

2

Connect the keyboard, mouse, and monitor (optional).

Connect the keyboard, mouse, and monitor (optional).

Connect the keyboard, mouse, and monitor (optional).

Connect the keyboard, mouse, and monitor (optional).

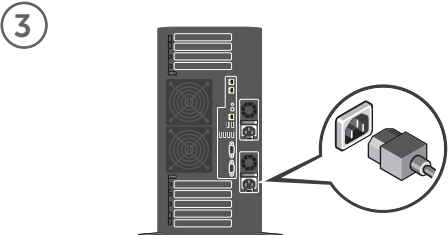

3

Connect the system to a power source.

Connect the system to a power source.

Connect the system to a power source.

Connect the system to a power source.



4

Loop and secure the power cable in the retention clip.

Loop and secure the power cable in the retention clip.

Loop and secure the power cable in the retention clip.

Loop and secure the power cable in the retention clip.

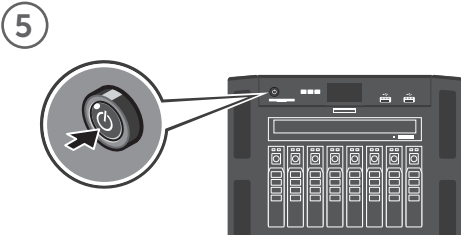

5

Turn on the system.

Turn on the system.

Turn on the system.

Turn on the system.

Dell End User License Agreement

Before using your system, read the Dell Software License Agreement that shipped with your system. If you do not accept the terms of agreement, see [dell.com/contactdell](#).

Save all software media that shipped with your system. These media are BACKUP copies of the software installed on your system.

Dell End User License Agreement

Before using your system, read the Dell Software License Agreement that shipped with your system. If you do not accept the terms of agreement, see [dell.com/contactdell](#).

Save all software media that shipped with your system. These media are BACKUP copies of the software installed on your system.

Dell End User License Agreement

Before using your system, read the Dell Software License Agreement that shipped with your system. If you do not accept the terms of agreement, see [dell.com/contactdell](#).

Save all software media that shipped with your system. These media are BACKUP copies of the software installed on your system.

Dell End User License Agreement

Before using your system, read the Dell Software License Agreement that shipped with your system. If you do not accept the terms of agreement, see [dell.com/contactdell](#).

Save all software media that shipped with your system. These media are BACKUP copies of the software installed on your system.

Technical Specifications

The following specifications are only those required by law to ship with your system. For a complete and current listing of the specifications for your system, see [dell.com/poweredgemanuals](#).

Power rating per power supply

1100W (Platinum) AC (100-240V, 50/60Hz, 12A-6.5A)

1100W (Platinum) DC (-(-48-60)VDC, 32A)

750W (Platinum) AC (100-240V, 50/60Hz, 10A-5A)

750W (Titanium) AC (200-240V, 50/60Hz, 5A)

495W (Platinum) AC (100-240V, 50/60Hz, 6.5A-3A)

NOTE: This system is also designed to be connected to IT power systems with a phase to phase voltage not exceeding 230V.

Batteries

System battery CR 2032 3.0-V lithium coin cell

Temperature

Maximum operation ambient temperature: 35° C

For information on supported expanded operating temperature range and configurations, see [dell.com/poweredgemanuals](#).

Technical Specifications

The following specifications are only those required by law to ship with your system. For a complete and current listing of the specifications for your system, see [dell.com/poweredgemanuals](#).

Power rating per power supply

1100W (Platinum) AC (100-240V, 50/60Hz, 12A-6.5A)

1100W (Platinum) DC (-(-48-60)VDC, 32A)

750W (Platinum) AC (100-240V, 50/60Hz, 10A-5A)

750W (Titanium) AC (200-240V, 50/60Hz, 5A)

495W (Platinum) AC (100-240V, 50/60Hz, 6.5A-3A)

NOTE: This system is also designed to be connected to IT power systems with a phase to phase voltage not exceeding 230V.

Batteries

System battery CR 2032 3.0-V lithium coin cell

Temperature

Maximum operation ambient temperature: 35° C

For information on supported expanded operating temperature range and configurations, see [dell.com/poweredgemanuals](#).

Technical Specifications

The following specifications are only those required by law to ship with your system. For a complete and current listing of the specifications for your system, see [dell.com/poweredgemanuals](#).

Power rating per power supply

1100W (Platinum) AC (100-240V, 50/60Hz, 12A-6.5A)

1100W (Platinum) DC (-(-48-60)VDC, 32A)

750W (Platinum) AC (100-240V, 50/60Hz, 10A-5A)

750W (Titanium) AC (200-240V, 50/60Hz, 5A)

495W (Platinum) AC (100-240V, 50/60Hz, 6.5A-3A)

NOTE: This system is also designed to be connected to IT power systems with a phase to phase voltage not exceeding 230V.

Batteries

System battery CR 2032 3.0-V lithium coin cell

Temperature

Maximum operation ambient temperature: 35° C

For information on supported expanded operating temperature range and configurations, see [dell.com/poweredgemanuals](#).

The following specifications are only those required by law to ship with your system. For a complete and current listing of the specifications for your system, see [dell.com/poweredgemanuals](#).

Power rating per power supply

1100W (Platinum) AC (100-240V, 50/60Hz, 12A-6.5A)

1100W (Platinum) DC (-(-48-60)VDC, 32A)

750W (Platinum) AC (100-240V, 50/60Hz, 10A-5A)

750W (Titanium) AC (200-240V, 50/60Hz, 5A)

495W (Platinum) AC (100-240V, 50/60Hz, 6.5A-3A)

NOTE: This system is also designed to be connected to IT power systems with a phase to phase voltage not exceeding 230V.

Batteries

System battery CR 2032 3.0-V lithium coin cell

Temperature

Maximum operation ambient temperature: 35° C

For information on supported expanded operating temperature range and configurations, see [dell.com/poweredgemanuals](#).

Copyright © 2014 Dell Inc. All rights reserved. This product is protected by U.S. and international copyright and intellectual property laws. Dell™ and the Dell logo are trademarks of Dell Inc. in the United States and/or other jurisdictions. All other marks and names mentioned herein may be trademarks of their respective companies.

Regulatory Model/type: E25S Series/E25S001

Printed in the U.S.A.

Copyright © 2014 Dell Inc. All rights reserved. This product is protected by U.S. and international copyright and intellectual property laws. Dell™ and the Dell logo are trademarks of Dell Inc. in the United States and/or other jurisdictions. All other marks and names mentioned herein may be trademarks of their respective companies.

Regulatory Model/type: E25S Series/E25S001

Printed in the U.S.A.

Copyright © 2014 Dell Inc. All rights reserved. This product is protected by U.S. and international copyright and intellectual property laws. Dell™ and the Dell logo are trademarks of Dell Inc. in the United States and/or other jurisdictions. All other marks and names mentioned herein may be trademarks of their respective companies.

Regulatory Model/type: E25S Series/E25S001

Printed in the U.S.A.

Copyright © 2014 Dell Inc. All rights reserved. This product is protected by U.S. and international copyright and intellectual property laws. Dell™ and the Dell logo are trademarks of Dell Inc. in the United States and/or other jurisdictions. All other marks and names mentioned herein may be trademarks of their respective companies.

Regulatory Model/type: E25S Series/E25S001

Printed in the U.S.A.



Scan to see how-to videos, documentation, and troubleshooting information.

Scan to see how-to videos, documentation, and troubleshooting information.

Scan to see how-to videos, documentation, and troubleshooting information.

Scan to see how-to videos, documentation, and troubleshooting information.

⚠ WARNING: A WARNING indicates a potential for property damage, personal injury, or death.

⚠ CAUTION: A CAUTION indicates potential damage to hardware or loss of data if instructions are not followed.

🔧 NOTE: A NOTE indicates important information that helps you make better use of your computer.

⚠ WARNING: A WARNING indicates a potential for property damage, personal injury, or death.

⚠ CAUTION: A CAUTION indicates potential damage to hardware or loss of data if instructions are not followed.

🔧 NOTE: A NOTE indicates important information that helps you make better use of your computer.

⚠ WARNING: A WARNING indicates a potential for property damage, personal injury, or death.

⚠ CAUTION: A CAUTION indicates potential damage to hardware or loss of data if instructions are not followed.

🔧 NOTE: A NOTE indicates important information that helps you make better use of your computer.

⚠ WARNING: A WARNING indicates a potential for property damage, personal injury, or death.

⚠ CAUTION: A CAUTION indicates potential damage to hardware or loss of data if instructions are not followed.

🔧 NOTE: A NOTE indicates important information that helps you make better use of your computer.

NOM Information:	
Importer	Dell Inc. de México, S.A. de C.V.Paseo de la Reforma 2620 -11º PisoCol. Lomas Altas11950 México, D.F.
Model number:	E25S
Supply voltage:	100–240 V CA (with 1100W, 750W, and 495W Platinum AC power supply units) 200–240 V CA (with 1600W Platinum, and 750W Titanium AC power supply units)
Frequency:	50Hz/60Hz (AC power supply unit)
Current consumption:	12A–6.5A (X2) (with 1100W Platinum AC power supply unit) 10A–5A (X2) (with 750W Platinum AC power supply unit) 5A (X2) (with 750W Titanium AC power supply unit) 6.5A–3A (X2) (with 495W Platinum AC power supply unit) 32A (X2) (with 1100W Platinum DC power supply unit)



09T5CMA00